

Customer:

Project:

Weight:

85 lbs

Colour:
Grey

Finish:
Smooth

Mark	Height	Width	Length	Qty
WSBP18	3"	18"	18"	----

Concrete:

- Ultimate 28 day compressive strength f_c' shall not be less than 40MPa
- Stripping compressive strength shall not be less than 10MPa
- Durability shall be class of exposure F2
- Maximum aggregate size of 14 mm.
- Maximum water/cement ratio of 0.45
- Air entrainment of 5-8%
- Reinforcing steel shall be deformed steel bars having a minimum yield strength of 400MPa conforming to CSA G30.18
- All concrete work shall conform to CSA-A23.1, A23.2, A23.3 and A23.4
- Minimum Rebar cover shall be as shown on the drawing but not be < 25mm (1")
- All tolerances according to CSA A23.4-09 Clause 12

Design Loads:

- Self weight

Notes:

Slab is NOT engineered. If engineering is required we will need to make a custom slab.

ISO VIEW

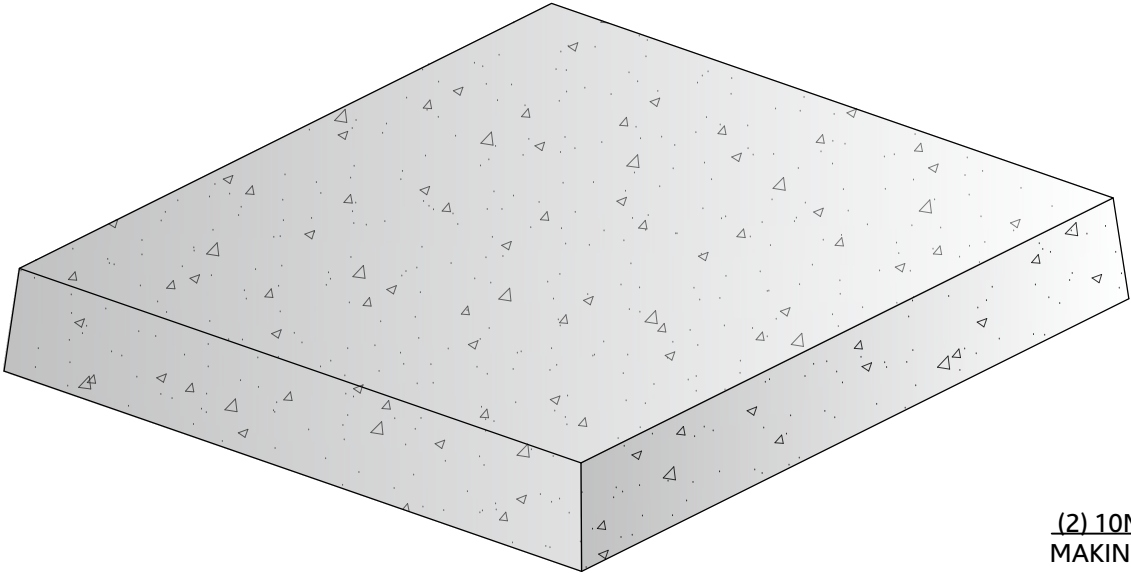

PLAN VIEW

(2) 10M REBAR
MAKING AN 'X'

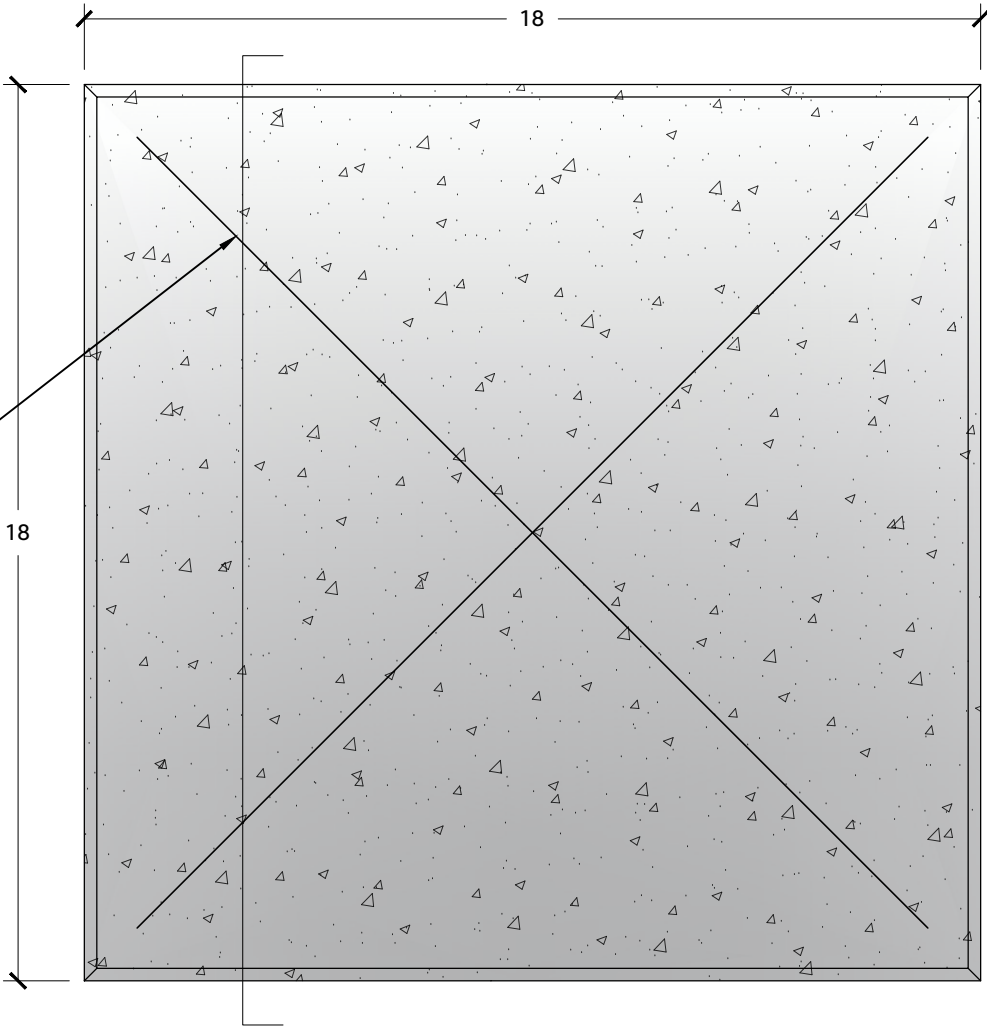

SECTION VIEW

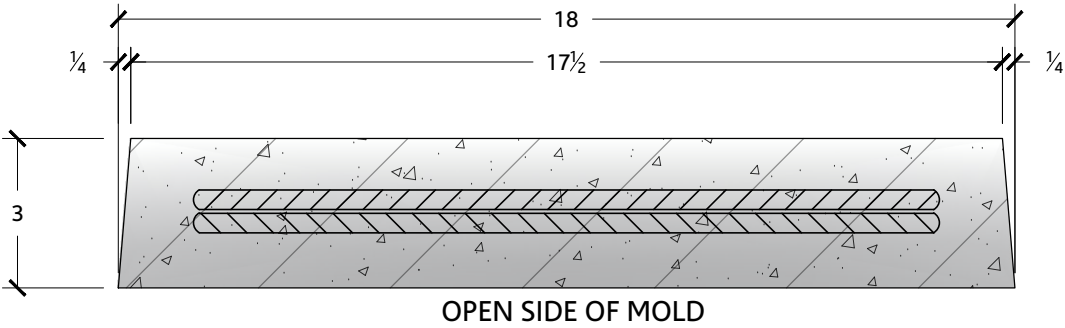

Piece:
Precast WSBP18 Trailer Pad

Date: 11/17/23

Detailer: C.A.

Scale:
1 1/2"=1'